

FORGE STORAGE CABINETS

Install Instructions

Tools Required

- Pencil
- Tape Measure
- Level (Small and Large)
- Small Crow Bar
- Hand Clamps
- Drill
- Drill Bit Sets and Screw Sets
- Circular Saw (w/Rip Fence) or Portable Table Saw

Hardware Included

- 16 - 5/8" Screws (per filler)

Optional Hardware (provided by installer)

- 2-1/2" Screws (attach cabinets together)

Installation

1. Place the cabinet in desired location and level it. Adjust the height of the cabinet using the adjustable levelers. Use a small crowbar to assist in lifting the cabinet to adjust the levelers.
2. If cabinet gets Filler Panel's measure the distance between the cabinet and wall at the top and bottom of the end panel, front and back of top panel, and the plinth base for the Storage Filler Panel (Figure A).
Optional: Mark the back wall with the end panel using a pencil to help realign the cabinet after filler panel is installed.
3. Mark the Filler Panel with dimensions from Step 1, drawing a straight line between the dimensions (Figure B). Cut the panel along the line using a circular saw or portable table saw. *Note: Tape along cut line on front side of panel to prevent tear out.*

Figure A

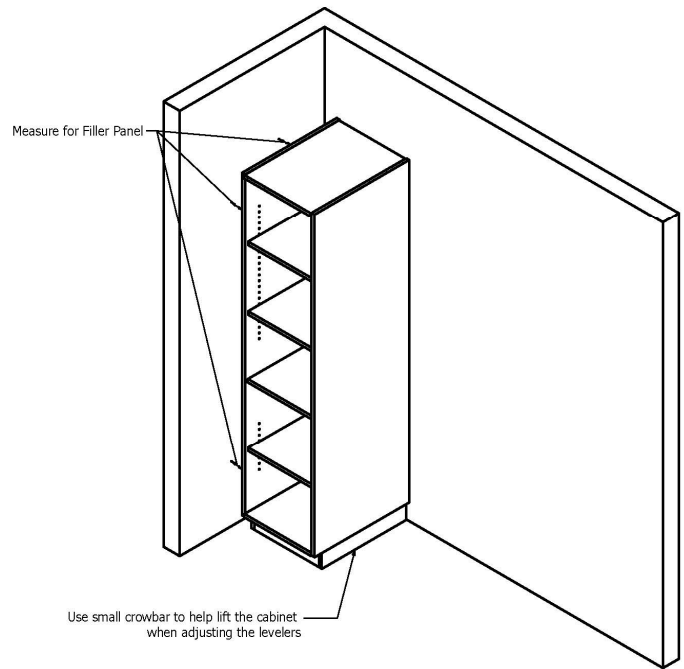
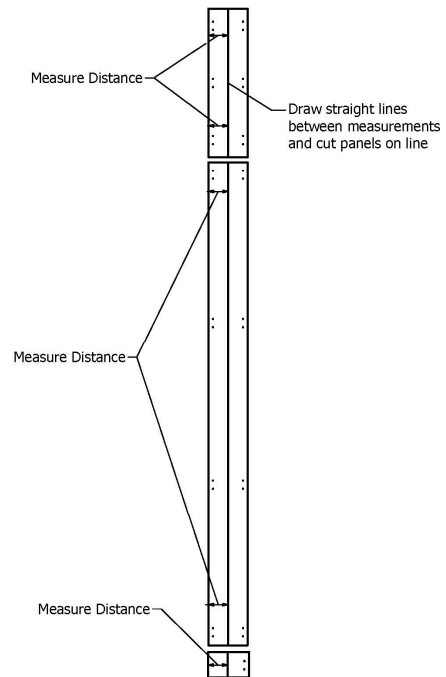

Figure B



FORGE BASE CABINETS

Install Instructions

4. Attach the Filler Panel to the cabinet (Figure C). Make sure the Filler Panel is flush with the front edge of the End Panel and Top Panel. Attach using the provided L-brackets and 5/8" screws. *Note: Hand Clamps can be used to secure the Filler Panel during attachment to the cabinet.*
5. Place the cabinet in position from Step 1. Make sure cabinet is in the correct location and make sure it is still level. Attach the cabinet to the wall screwing through the back panel into the substructure of the wall (Figure D). *Note: If no stud is available toggle anchors must be used. Drill holes in back panel, remove the cabinet from the wall and install the anchors to the wall using the drill holes. Replace the cabinet and fasten to wall.*

STORAGE CABINETS MUST BE ANCHORED TO THE WALL.

Figure C

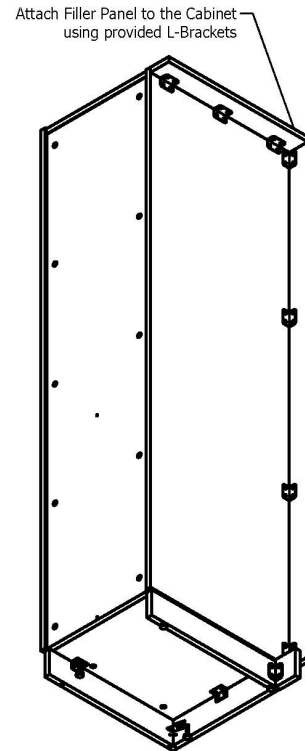

Figure D

